

## AccuGlide Tracks

Our tracks are designed to set up and handle with as little effort as possible. A variety of options are available for individual fabrication requirements.

Tracks are constructed of heavy gauge polished stainless steel with laser-cut stainless attachments. Our tracks have twice the wall thickness as any other rail saw available. This allows the AccuGlide to hold a level of precision and durability that is thoroughly unmatched. We pay special attention to precision straightening, high quality adhesives and strict manufacturing quality control.

Positioning Tracks to your cut line takes just seconds with our patented Calibration Indicators. Watch the short video at [AccuGlideSaws.com](http://AccuGlideSaws.com).

- A. Heavy gauge stainless steel - Twice as thick as the copycats
- B. Quick-Lock Suction Cups for extra hold-down power on cross cuts\*
- C. EZ-Cut Track™ with convenient 90 degree fence and suction cups
- D. Tracks under-surfaced with durable wear-resistant rubber

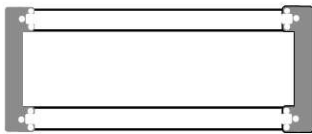
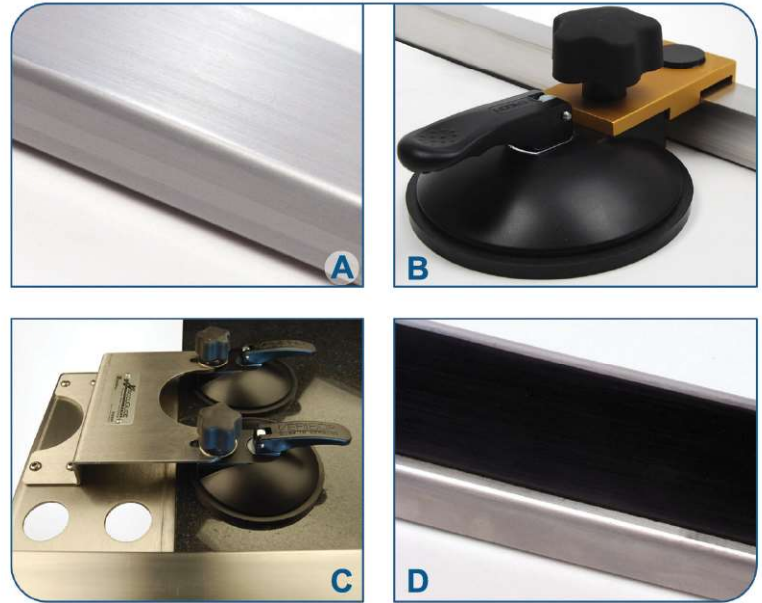

**Standard Tracks** are attached at ends with laser-cut stainless hardware. No clamping required.

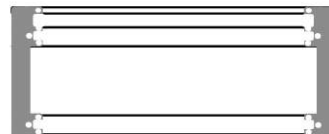

**Quick-Lock Tracks** include an integrated aluminum clamping rail: C-Clamp or Suction Cup ready.



**Solid-Connect Tracks** include a 7.5' & 5' length with solid bolt-up. EZ-Cut™ & Quick-Lock features optional.

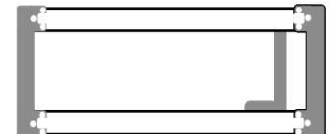

**5' EZ-Cut™** includes an adjustable 90° fence & suction cups.

Description	Item #
12.5' Standard Tracks	T12500G
7.5' Standard Tracks	TR50105G
7.5' Quick-Lock Tracks	TR75
6.5' Quick-Lock Tracks	TR65
5' Standard Tracks	TR50147G

Description	Item #
5' Quick-Lock Tracks	TR50
5'+7.5' Solid-Connect Tracks, options available	TR031
5' EZ-Cut™ Track	TRET5
Set 4.5" Quick-Lock Suction Cups, reversible *	TRSC2
Interlocking Tracks, for floor & concrete	Call

\* AccuGlide Quick-Lock Suction Cups or regular C-Clamps are recommended for working on undersized tables, very small pieces of stone, warped material, and whenever Tracks cannot be sufficiently balanced on the work piece or shimmed for sufficient support.

Specifications	12.5' length	7.5' length	6.5' length	5' length	5' EZ-Cut™
Maximum cut length	133" (330 cm)	73" (185 cm)	61" (155 cm)	42" (106 cm)	36" (91 cm)
Quick-Lock option available		✓	✓	✓	n/a
Quick-Lock Suction Cup compatible	✓	✓	✓	✓	n/a
Built-in suction cups					✓
Thick-wall (.120 gauge) stainless steel	✓	✓	✓	✓	
Clamping required	no	no	no	no	no
Compare to Find Your Ideal Combination					
Customer-preferred combo for full slab fabrication	✓	✓			
MiterMaster™ friendly	✓	✓	✓		
Prefabricated counter top friendly		✓	✓	✓	✓
Travel friendly		✓	✓	✓	✓
Use Calibration Indicators to set up in seconds	✓	✓	✓	✓	✓