

AccuGlide Saws ride on four Glide Pins (black Teflon®-like threaded bolts, with brass heads). The two Glide Pins closest to the blade will wear more quickly because of abrasive stone slurry which can cause the AccuGlide to cut out of square. We recommend re-adjusting the Glide Pins every 20-30 operating hours to maintain a square cut. Glide Pin adjustment is simple and should only take a few minutes.

To Adjust Glide Pins (Every 20-30 Hours):

1. Place the tracks in position on a clean piece of stone (do not adjust on an uneven table). Place the saw on the tracks with the blade facing towards you. Loosen the four lock nuts on the Glide Pins.

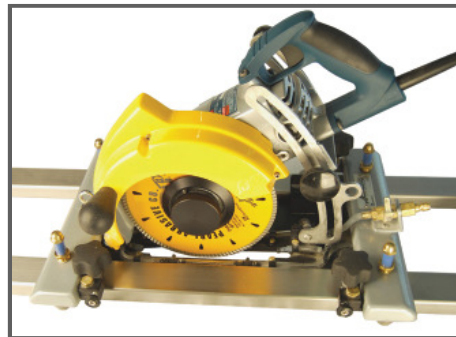

NOTE: to install new Glide Pins, first remove the old pins counterclockwise and clean the threaded holes. Replace with new Glide Pins and turn them clockwise, 3/16" to 1/4" past the bottom of the saw.

2. Place a small machinist square on the track with the longest edge of the square resting against the core of the diamond blade (machinist squares are available from AccuGlide Saws).

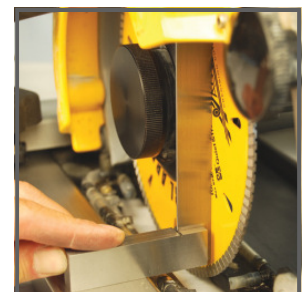

3. Visually check for a gap between the square and the blade.

A) If there is a gap at the bottom of the square, turn the two blade-side Glide Pins evenly until no light shows through between the blade and square.

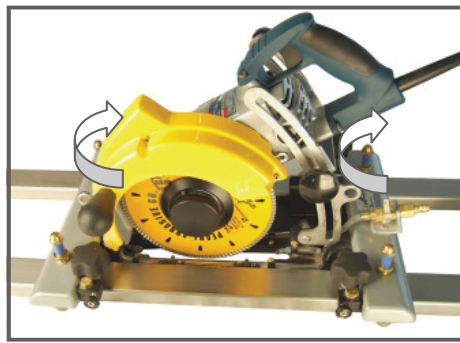
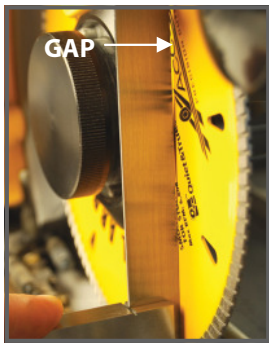
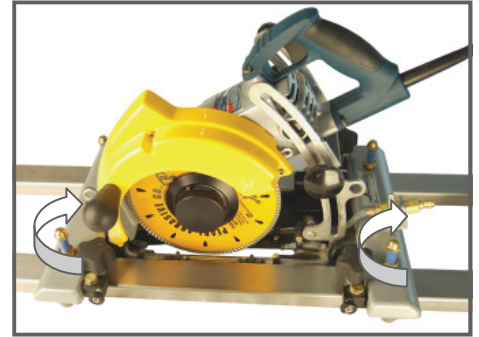

B) For a gap at the top of the square, adjust the two motor-side Glide Pins evenly until no light shows through between the blade and square.

4. Check for diagonal rock. Place your fingers next to the front blade-side pin and the back motor-side pin and check for rocking. If rocking occurs, carefully turn down the pin that is high until it touches the track. Repeat for the opposite two pins.

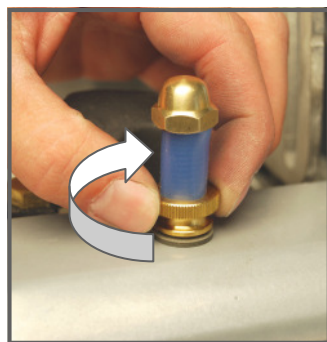
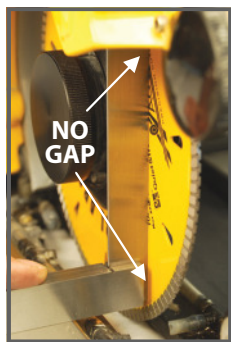
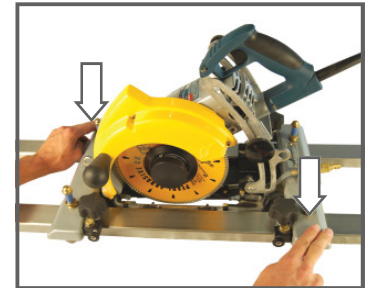
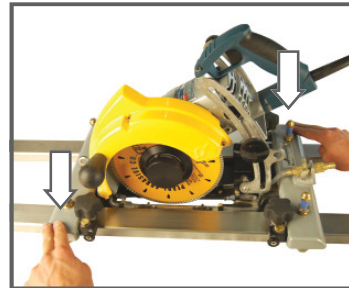

5. When the blade is square on the track and no rocking occurs, tighten the brass lock nuts clockwise. Be careful not to turn the Glide Pins while tightening.

Visually check to ensure there is a minimum of 1/8" clearance between the stone and the base of the saw. You're finished!

NOTE: Keep in mind that when adjustment is complete, there may be a variation in the Glide Pin length exposed under the saw. Replacement Glide Pins are only available from AccuGlide Saws.